

CASE STYLE "A"

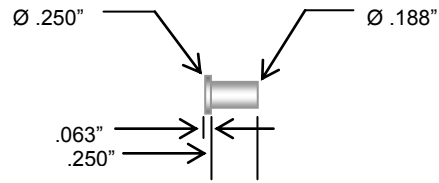

CASE STYLE "B"

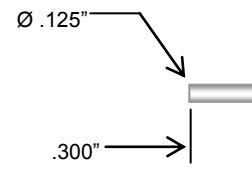

CASE STYLE "C"

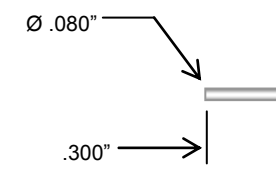

CASE STYLE "D"

- T130- Type T Wire
- T131- Type J Wire
- T132- Type E Wire
- T133- Type K Wire

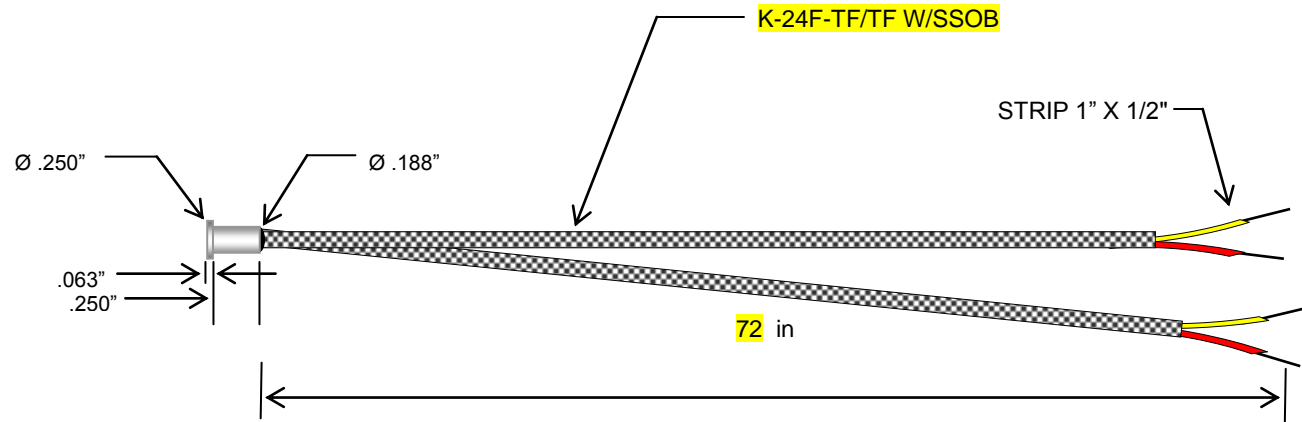

- .188"Ø X
- .215"Ø X
- .250"Ø X
- .375"Ø X



FEEDTHRU OPTION



SPRING



STAR WASHER

Large (.175"ID) \_\_\_\_\_

Small (.136"ID) \_\_\_\_\_

PARTS WILL INCLUDE SMALL CLIP UNLESS NOTED OTHERWISE

Approved by: \_\_\_\_\_ Ref: \_\_\_\_\_

**Specifications**

**ELEMENT:** TYPE-K (CHROMEL/ALUMEL)

**CONFIG:** Dual Ungrounded

**TEMP RANGE:** -180 to 260°C (-300 to 500°F)

**CASE:** 300 series Stainless Steel

**LEADS:** Teflon jacket/Insulation/SSOB. (Teflon 0-500°F)

18714 PARTHENIA STREET - NORTHRIDGE - CALIFORNIA 91324 - USA

PHONE: (818) 886-3755 - FAX: (818) 772-7690

PRODUCTION CODE: **SS-125-D-K-U-.30-L3-72-SS72-BW-0**



PART NO. **XXXX-XXXXXXXX**

OCR # **XXXXX**

DESCRIPTION:

DATE: **XX/XX/XX**

REV: NC